

Publish Notes – Desktop Application

Asgard Desktop Application v2.2.0



Affected Workflows

PUBLISH NOTES – DESKTOP APPLICATION	1
ASGARD DESKTOP APPLICATION v2.2.0	1
MOBILE APPLICATIONS	2
ASGARDMOBILE 2.0	2
DESKTOP APPLICATION	3
MAINTENANCE	3
BILLINGS	3
WORK ORDERS	4
CLEANS	4
ASSETS & RESERVES	5

Mobile Applications

AsgardMobile 2.0

Mobile Dispatcher

This publish, we added the following abilities to the Dispatcher workflow:

- Add / Save filter criteria
- View Work Order Details
- Assign Work Order
- Start Work Order
- Complete Work Order
- Suspend Work Order

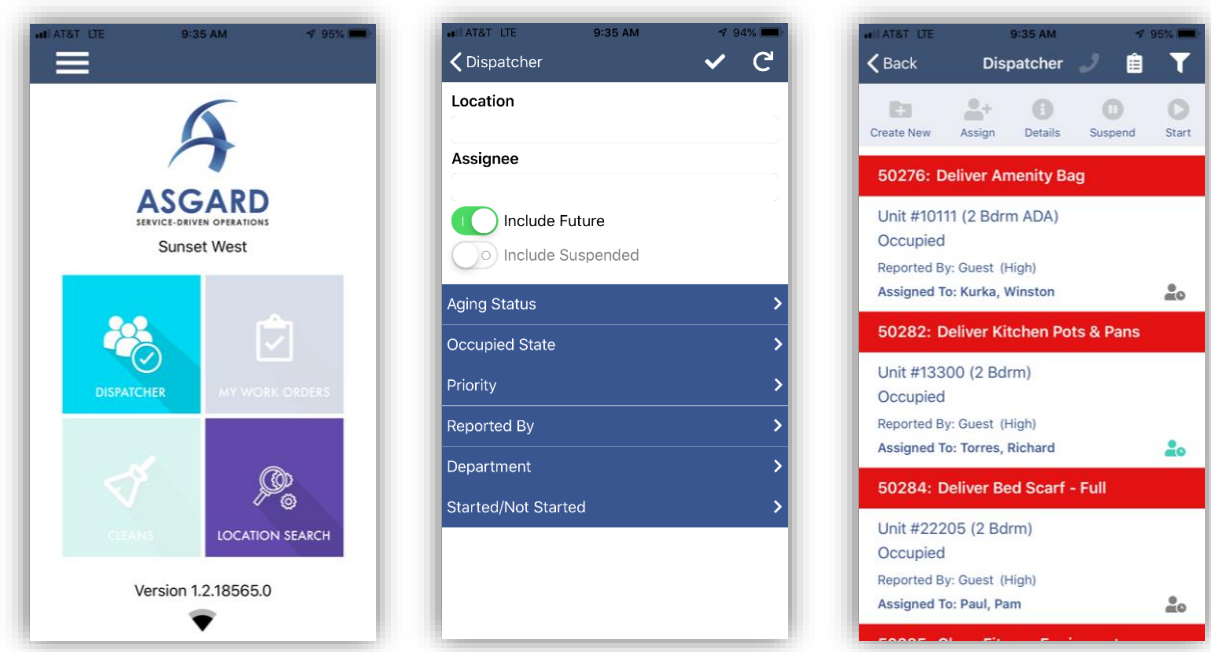

Highlights of new functionality

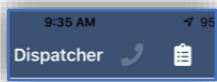

Toggle between Dispatching Standard and Inspection Work Orders, using the phone and checklist icons at the top of the screen

Easily identify started work orders, by the human/clock icon – It is highlighted when the work has been started

To perform actions on work orders in the list, click the work order and relevant buttons will dynamically appear on the toolbar. For example, an unstarted work order will give the option to Start. A started work order will give the option to Complete.

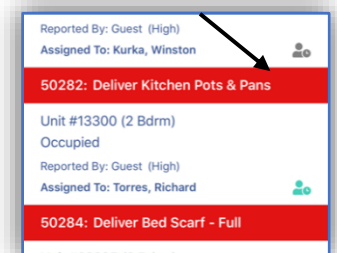

The next functionality on our mobile roadmap is the ability to Create Work Orders and the User Work Order list, which will contain Standard, PM, and Inspection assignments. For questions, concerns, or assistance getting started contact support@katanasoft.com.

Desktop Application

Maintenance

Various Fixes / Changes

Small enhancements and fixes, in various areas of the system, arising from automated reporting of system performance and user experience reports. Specific improvements made to error handling, performance of Occupied Status API/Import, Asset/Reserve Changes, and the PM/Inspection Matrix.

Billings

Active Billings, Enhance Screen to Include Labor Data

By customer request, we have added Labor details, including rates and minutes, to the Active Billings screen. This information is viewable in two ways:

Add Columns, which can be added by right-clicking and selecting Show/Hide Columns:

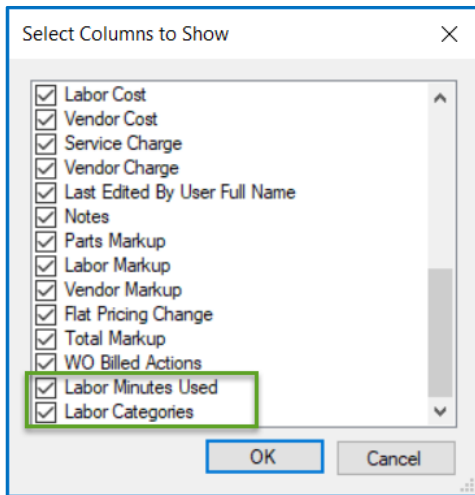

Department	Labor Categories	Labor Minutes Used
Engineering	BM Tech 2 Day 1 - S...	675
Maintenance	BM Tech 2 Day 1 - S...	480
Maintenance	Tech 1 Day 1 - Journ...	360
Maintenance	BM Tech 1 Day 1 - S...	360
Management	BM Tech 2 Day 1 - S...	330

Or, expand the details of the Billing Line, to see more extensive information:

Billing ID	Date of Work	Last Assignee	Status	Unit	Billing Period	Owner Account #	Bill To	Charge	Description	Notes	In Rental Program?
WO:230146	10/10/2018		Needs Approval		November, 2018			585.00	Repair Ceiling - Dam...		<input checked="" type="checkbox"/>
Labor Categories											
Drag a column header here to group by that column											
Name	Worked By	Labor Date	Usual Cost/hour	Minutes	Total Cost	Total Price	Billed Action				
BM Tech 2 Day 1 - Skilled		9/28/2018	\$52.00	60	\$52.00	\$52.00	In Unit Repair - Bill To Owner				
BM Tech 2 Day 1 - Skilled		10/7/2018	\$52.00	90	\$78.00	\$78.00	In Unit Repair - Bill To Owner				
BM Tech 1 Day 3 - Skilled		10/7/2018	\$52.00	45	\$39.00	\$39.00	In Unit Repair - Bill To Owner				
BM Tech 1 Day 2 - Skilled		10/7/2018	\$52.00	180	\$156.00	\$156.00	In Unit Repair - Bill To Owner				
BM Tech 2 Day 2 - Skilled		10/8/2018	\$52.00	120	\$104.00	\$104.00	In Unit Repair - Bill To Owner				
BM Tech 1 Day 1 - Skilled		9/28/2018	\$52.00	180	\$156.00	\$156.00	In Unit Repair - Bill To Owner				

Work Orders

Ability to Edit Comments / Add Hyperlinks

Users with the Edit Locked Fields permission can now edit existing Comments

- A log entry is created when Edits are made, to maintain a clear record of work order changes.
- Photos cannot be edited
- Hyperlinks can now be added and edited – To open a hyperlink, from the main app, use ctrl+click

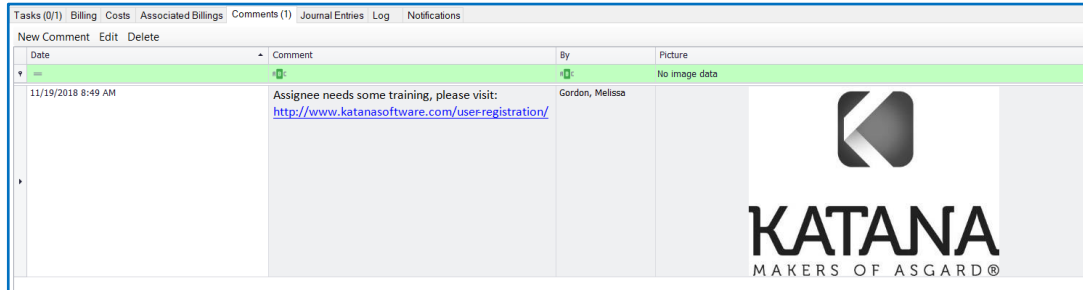

Note: The workflows are unchanged for mobile comment entry and comments added during work order completion.

For questions, or to request this permission, contact support@katanasoft.com.

Cleans

Enhancements/Optimizations to Various Workflows:

- Reduce Active Cleans Refresh to every 15 minutes – User can manually refresh, at any time
- Improved efficiency of refresh process
- Alphabetized Assignees by Last Name in Active Cleans Assignee selector
- Reported By (Guest, Staff, etc.) now shows on Active Cleans screen
- Time Counters, including Estimated Time Remaining, Estimated Clean Time, and Work Time, now sortable
- Cleans Templates screen enhanced to match other grids

Assets & Reserves

Account List, Reports, Add Useful Life Avg to Reserve Analysis Report

This report gives a quick snap shot of what life an asset (Detailed) or asset category (Summary) is expected to have, and how prepared the site is to fund the replacement.

By customer request, we have moved the Item Count in the summary line (bold) closer to the "Total" column, and added an average of the Useful Life for the items listed.

<u>Expense</u>	<u>Useful Life</u>	<u>Remaining Life</u>	<u>Cost if Replaced in FY2018</u>	<u>FY2018 Balance Allocation</u>	<u>Ideal Funding (Year Start)</u>	<u>FY2018 Income Allocation</u>	<u>Percent Funded</u>
Building Painting							
Paint-Exterior 10 Year-5600 Bldg	10.0	2.4	5,644	0	4,155	1,217	0.00%
Paint-Exterior 10 Year-Bldg 6001	10.0	8.0	11,544	0	2,241	0	0.00%
Paint-Exterior 10 Yr-Ph 1A	10.0	2.4	380,783	280,350	280,350	46,489	100.00%
Paint-Exterior 10 Yr-Ph 1B	10.0	2.6	570,890	411,078	411,078	69,421	100.00%
Paint-Exterior 10 Yr-Ph 2	10.0	4.0	297,578	173,346	173,346	34,958	100.00%
Paint-Exterior 10 Yr-Ph 3A	10.0	4.0	111,591	65,005	65,005	13,109	100.00%
Paint-Exterior 10 Yr-Ph 3B	10.0	6.0	128,226	3,176	49,797	4,318	6.38%
Paint-Exterior 10 Yr-Ph 3C	10.0	6.0	272,782	6,757	105,035	9,485	6.38%
Paint-Exterior 5 Year-Ph 9	10.0	4.4	111,054	3,840	60,199	4,908	6.38%
Paint-Metal-5600 Bldg	5.0	2.0	2,825	0	1,645	568	0.00%
Paint-Metal-Bldg 6001	5.0	3.0	2,825	0	1,097	426	0.00%
Paint-Wood Exterior-5600 Bldg	5.0	2.0	2,825	0	1,645	568	0.00%
Paint-Wood Exterior-Bldg 6001	5.0	3.0	2,825	0	1,097	426	0.00%
Building Painting Total	30 Items	9	5,138,035	2,146,889	2,728,910	279,882	