

# Publish Notes

AsgardMobile v2.17.0 / Desktop Application v2.17.0



**KATANA**  
FACILITY MANAGEMENT



## Desktop Application

### Maintenance/Performance/Errors

We made various enhancements and fixes, in several areas of the system, arising from user reports, automated reporting, and performance records/logs. Some of these changes include, but are not limited to:

- Purchase Approvals, Fix to Approver column on the active request list
- Purchase Approvals, Fix to error when changing account on request draft
- Assets & Reserves, Fix to error when changing Assets associated with a Project



## Mobile Applications

### AsgardMobile 2.0

#### Maintenance/Performance/Errors

We made various enhancements and fixes, in several areas of the system, arising from user reports, automated reporting, and performance records/logs. Some of these changes include, but are not limited to:

- Better Device statistics tracking
- Display Sublocation for Location-Based Tasks
- Display Quantity for Stock Item Based Tasks
- Added various new “Loading” indicators for better user experience
- Styling of Sub-Menu Items on Main Menu
- Moved Warning Bubbles for Actions Taken

#### Work Orders, Trigger Assignment Options at Create

By User request, we have moved the “Self Assign” option to pop up when the user clicks Create on a work order. This allows them to choose the appropriate assignment mode, easily, while out in the field.



#### Compress Photo Comments to Decrease Data Transfer

Photo Comments will now be compressed when posted to a Work Order. Users will experience quicker processing times with no reduction in quality.

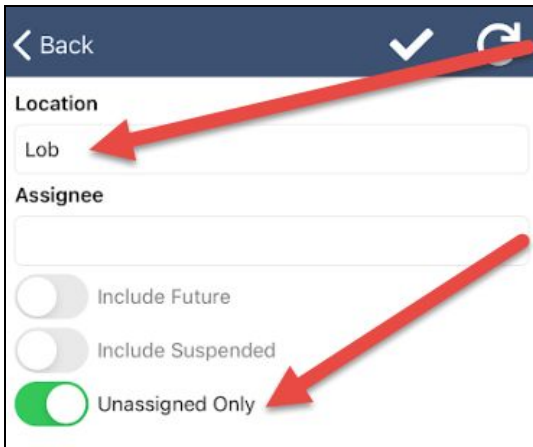

### Dispatcher List, Enhanced Location Filter to 3 Character Match

Previously, users were required to enter in a full location name to filter on the Dispatch list. To help simplify filtering by location, we have updated the search criteria to be a three-character match. For example, to filter by Lobby, users can enter in “Lob” for a quick search.

### Dispatcher List, Added “Unassigned Only” Filter

By user request, we have added “Unassigned” to the Dispatcher filter options. When this filter is flagged, only Unassigned work orders will appear in the list.

### Increased Labor Time Max

We have increased the maximum labor time from 3 hours (180 minutes) to 8 hours (480 minutes) per labor entry to accommodate all-day projects.

### Further Localization

We have continued to enhance localization/translations throughout the application for our non-English speaking users.

In addition to items that were previously localized, users will now also find the following items conveniently translated:

- Break Status
- All Work Order Tasks Including at Creation and Completion
- Inspections Template Names
- Creation and Completion Confirmation
- Actions Taken on all Work Order Types
- Menu Titles
- Loading Indicators
- Search and Dispatch Filters

We have also enhanced translations to only require the user to set their user profile in Asgard to apply all translations (previously, users needed to also change phone settings).