

Adding Parts Using Category or Item Search for iPhone

1. Open work order and tap **Costs** to access Parts and Labor

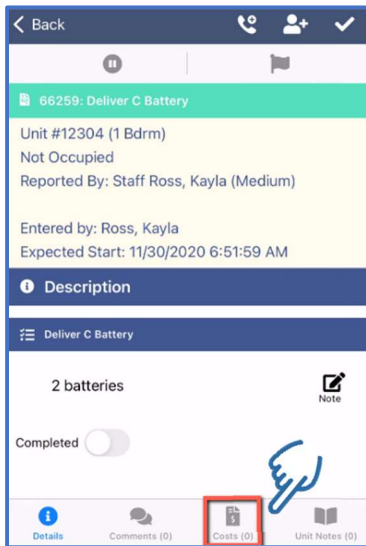

2. Tap **New Part**



Search by **Category** or Part

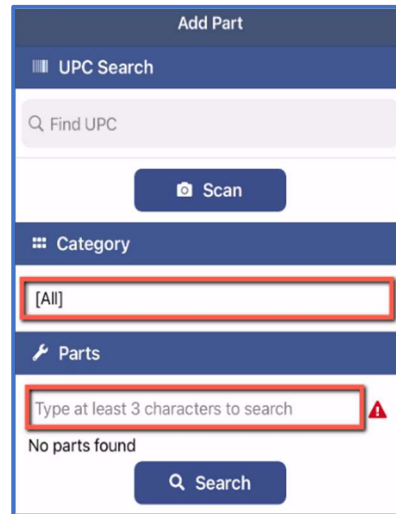

3. Select a **Category** from the list

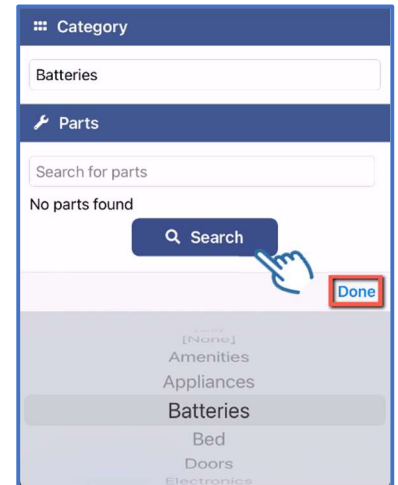

Or type at least 3 characters into the **Parts** field

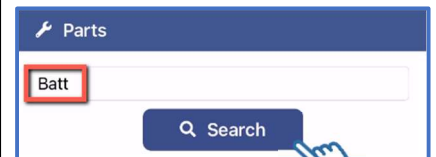

Tap **Search**

4. Select **Stock Item** from list, tap **OK**

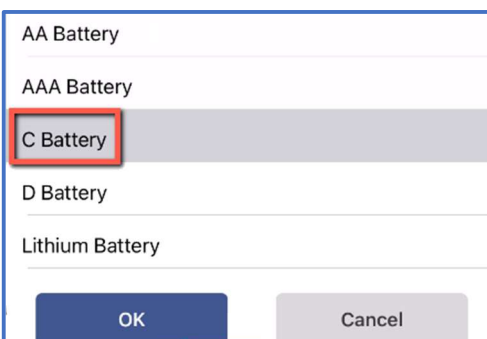

5. Choose **Quantity** and **Stock Room** tap **OK**

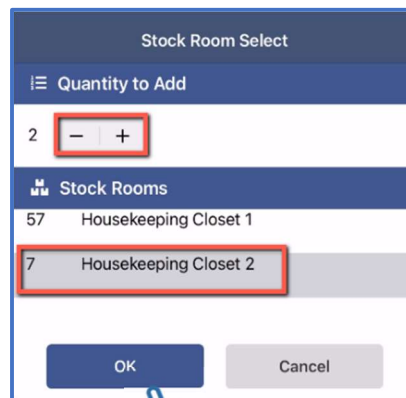

6. Confirm information is correct

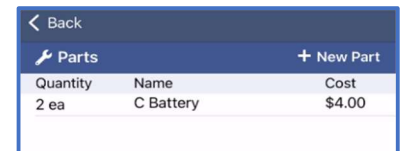

To Edit Stock Item, swipe left and tap **Edit** or **Remove**

